

Transmission KTM10DA

Spare parts

Ersatzteile

Pièces détachées

Reserve onderdelen

Repuestos

Reservdelar

ACTUAL PARTS
 MAY NOT APPEAR
 AS SHOWN

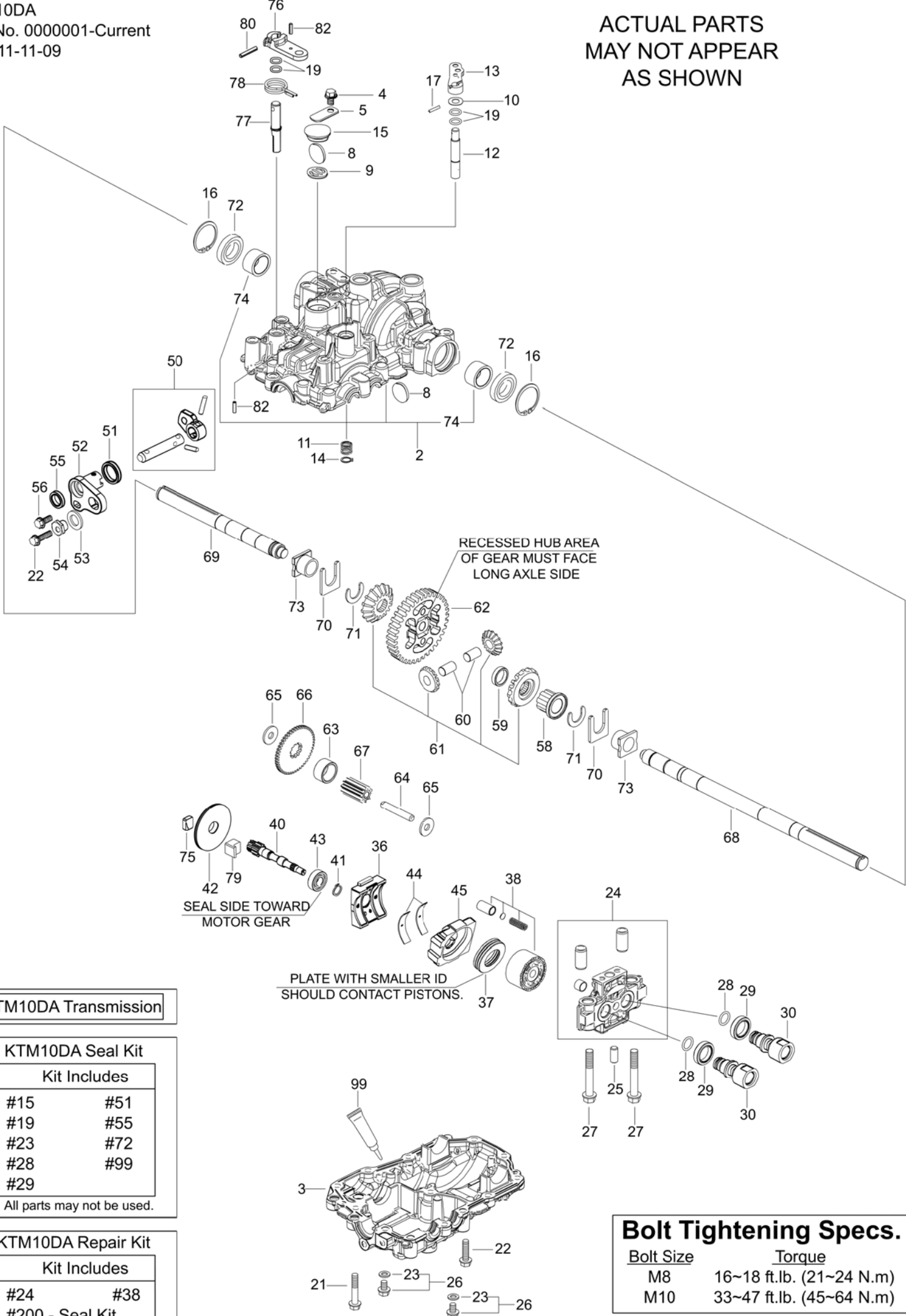

1- KTM10DA Transmission

200- KTM10DA Seal Kit

Kit Includes	
#15	#51
#19	#55
#23	#72
#28	#99
#29	

All parts may not be used.

201- KTM10DA Repair Kit

Kit Includes	
#24	#38
#200 - Seal Kit	

All parts may not be used.

Bolt Tightening Specs.

Bolt Size	Torque
M8	16~18 ft.lb. (21~24 N.m)
M10	33~47 ft.lb. (45~64 N.m)

(KTM10DA-HUSQVARNA / 787K0024080 & 81)

HUSQVARNA AB (52333)

ID Number	TTC Part No.	Part Description	Service Part
1	787K0024081	KTM10DA TRANSAXLE	
2	187K0024280	UPEER HOUSING ASY.	
3	187K0024171	LOWER CASE	502 45 56-01
4	26106080122	BOLT 8 * 12	535 40 28-52;535 41 47-43
5	187K0024380	PLATE	502 45 58-01
8	19216324360	MAGNET 28 * 3.5	535 40 28-29
9	1A646029000	MAGNET HOLDER	502 45 20-01
10	19843575630	WASHER 10.5*20*1	502 46 08-01
11	187K0024780	BYPASS SPRING	502 45 62-01
12	187K0024760	BYPASS SHAFT	
13	1A632029520	BYPASS LEVER	535 40 28-17
14	22242000120	SNAP RING 12	502 46 12-01
15	1C655036300	SEALING CAP 30	535 40 28-32
16	22252000420	SNAP RING 42	502 46 15-01
17	22351030020	SPRING PIN 3.0A * 20	535 40 28-16
19	24311000120	O-RING 1A P12	535 41 46-19
21	26106080452	BOLT 8 * 45	535 41 47-06
22	26106080302	TAPPING BOLT 8 * 30	
23	22190080000	SEAL WASHER 8	506 95 75-01
24	187K0024561	CENTERCASE D	502 45 59-01
25	22312100200	DOWEL PIN 10 * 20	502 46 16-01
26	187Q0399940	DRAIN BOLT KIT	577 32 58-01
27	26106100702	BOLT 10 * 70	
28	24315000140	O-RING P14.0	502 46 21-01
29	24421203007	SEAL TC203007	502 46 24-01
30	187K0024930	CONNECTOR G1/2	
36	187K0024821	THRUST METAL RETAINER	502 45 64-01
37	1A632024240	BEARING THS060513	502 44 92-01
38	168H3029550	CYLINDER BLOCK CMP	502 45 37-01
40	187K0025362	MOTOR SHAFT/ GEAR D(9T)	502 45 69-01
41	19215425310	SNAP RING S15	535 40 28-81

42	187K0036340	BRAKE DISK D	
43	168T2025280	BEARING 6202 RSR C3	535 40 28-83
44	19215427051	THRUST METAL	535 41 46-86
45	187K0024700	SWASH PLATE	502 45 60-01
50	187K0029650	CONTROL SHAFT ASSY	502 45 74-01
51	24421253506	SEAL TC253506	502 46 26-01
52	187K0029710	CONTROL BUSHING	502 45 76-01
53	22137160000	WASHER 16	502 46 10-01
54	187K0029700	AJUSTER BUSHING	502 45 75-01
55	19406527270	SEAL TC 162606	535 40 28-11
56	26106080202	BOLT 8 * 20	535 41 47-05
58	1A632034280	COLLAR 25.4	
59	187K0034310	AXLE COLLAR	
60	1A632031810	DIFFERENTIAL PINION PIN	535 41 46-38
61	1A632031501	DIFFERENTIAL GEAR KIT	502 44 94-01
62	187K0033640	FINAL GEAR (54T)	502 45 83-01
63	187K0033260	FINAL PINION COLLAR	
64	1A646033410	REDUCTION SHAFT	535 41 46-06
65	19216833420	WASHER 12 * 32 * 3.2	502 46 07-01
66	187K0033481	REDUCTION GEAR D (40T)	502 45 80-01
67	1A646033531	FINAL PINION GEAR (10T)	502 45 27-01
68	187K0034350	AXLE SHAFT	
69	187K0034360	AXLE SHAFT	
70	1A632034290	THRUST WASHER	535 41 46-45
71	19216734160	RETAINING RING 23	535 41 46-96
72	19215434270	SEAL S 25.4 * 42 * 8	535 40 28-10
73	19216734240	BUSHING 25.4	535 41 46-97
74	187K0034500	BUSHING 25.	
75	1A646036121	BRAKE SHOE	535 41 46-16
76	1A646036160	BRAKE LEVER	535 40 28-38
77	1A646036171	BRAKE SHAFT	535 41 46-17
78	1A646036180	BRAKE RETURN SPRING	502 45 28-01
79	1A646036200	BRAKE ACTUATOR	535 41 46-18
80	22351050032	SPRING PIN 5 * 32	535 40 28-40
82	22351040016	SPRING PIN 4 * 16	535 40 28-41
99	1A646099500	SEALANT	502 45 34-01;505 34 87-01
200	187K0099000	SEAL KIT	502 45 97-01